

**MALE CONNECTOR (STUD END PARALLEL THREAD) WITH ELASTOMERIC SEAL
METRIC OD TUBES X BSP THREAD-G**

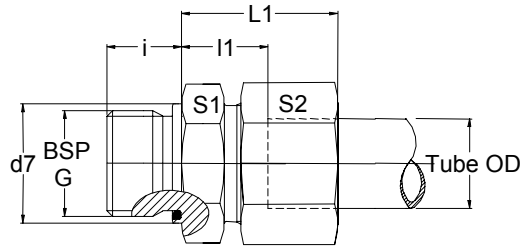

SERIES	TUBE OD.	S1	S2	L1	l1	i	d7	G	PART NO.	
										METRIC SIZE TUBE
L	250 Kg/cm ²	6	14	14	23	8.5	8	14	1/8"	MC6L-G2-es
		8	19	17	25	10	12	19	1/4"	MC8L-G4-es
		10	19	19	26	11	12	19	1/4"	MC10L-G4-es
		12	22	22	27.5	12.5	12	22	3/8"	MC12L-G6-es
		15	27	27	29	14	14	27	1/2"	MC15L-G8-es
	160 Kg/cm ²	18	27	32	31	14.5	14	27	1/2"	MC18L-G8-es
		22	32	36	33	16.5	16	32	3/4"	MC22L-G12-es
		28	41	41	34	17.5	18	40	1"	MC28L-G28-es
	100 Kg/cm ²	35	50	50	39	17.5	20	50	1 1/4"	MC35L-G20-es
		42	55	60	42	19	22	55	1 1/2"	MC42L-G24-es
H	630 Kg/cm ²	6	19	17	28	13	12	19	1/4"	MC6H-G4-es
		8	19	19	30	15	12	19	1/4"	MC8H-G4-es
		10	22	22	31.5	15	12	22	3/8"	MC10H-G6-es
		12	22	24	32.5	17	12	22	3/8"	MC12H-G6-es
		14	27	27	37	19	14	27	1/2"	MC14H-G8-es
	400 Kg/cm ²	16	27	30	37	18.5	14	27	1/2"	MC16H-G8e-s
		20	32	36	43	20.5	16	32	3/4"	MC20H-G12-es
		25	41	46	47	23	18	40	1"	MC25H-G16-es
	250Kg/cm ²	30	50	50	50	23.5	20	50	1 1/4"	MC30H-G20-es
		38	55	60	57	26	22	55	1 1/2"	MC38H-G24-es

S.D.INDUSTRIES.

An ISO 9001 : 2000 Company

Hydraulics, Pneumatics, Instrumentation Fittings, Manifolds & Valves

2/10, Singh Industrial Estate, Ram Mandir Road, Goregaon (W), Mumbai-400 104, India

◆ Phone: +91 22 28724724, +91 22 28738511 ◆ Fax: +91 22 28752130

◆ Email: sdind@vsnl.com ◆ www.sdinds.com

"We Deliver Confidence Through Quality Products."

**MALE CONNECTOR (STUD END PARALLEL THREAD) WITH ELASTOMERIC SEAL
METRIC OD TUBES X METRIC THREAD-M**

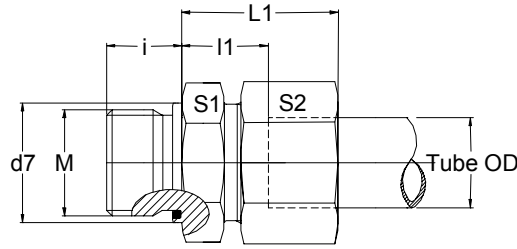

SERIES	TUBE OD.	S1	S2	L1	l1	i	d7	METRIC THREAD		
								M	PART NO.	
L	250 Kg/cm ²	6	14	14	23	8.5	8	14	M10 X 1	MC6L-M10-es
		8	17	17	25	10	12	17	M12 X 1.5	MC8L-M12-es
		10	19	19	26	11	12	19	M14 X 1.5	MC10L-M14-es
		12	22	22	27.5	12.5	12	22	M16 X 1.5	MC12L-M16-es
		15	24	27	28.5	13.5	12	24	M18 X 1.5	MC15L-M18-es
	160 Kg/cm ²	18	27	32	31	14.5	14	27	M22 X 1.5	MC18L-M22-es
		22	32	36	33	16.5	16	32	M26 X 1.5	MC22L-M26-es
		100 Kg/cm ²	28	41	41	34	17.5	18	40	M33 X 2
	35		50	50	39	17.5	20	50	M42 X 2	MC35L-M42-es
		42	55	60	42	19	22	55	M48 X 2	MC42L-M48-es
H	630 Kg/cm ²	6	17	17	28	13	12	17	M12 X 1.5	MC6H-M12-es
		8	19	19	30	15	12	19	M14 X 1.5	MC8H-M14-es
		10	22	22	31.5	15	12	22	M16 X 1.5	MC10H-M16-es
		12	24	24	33.5	17	12	24	M18 X 1.5	MC12H-M18-es
		14	27	27	37	19	14	27	M20 X 1.5	MC14H-M20-es
	400 Kg/cm ²	16	27	30	37	18.5	14	27	M22 X 1.5	MC16H-M22-es
		20	32	36	43	20.5	16	32	M27 X 1.5	MC20H-M27-es
		25	41	46	47	23	18	40	M33 X 2	MC25H-M33-es
	250 Kg/cm ²	30	50	50	50	23.5	20	50	M42 X 2	MC30H-M42-es
		38	55	60	57	26	22	55	M48 X 2	MC38H-M48-es

S.D.INDUSTRIES.

An ISO 9001 : 2000 Company

Hydraulics, Pneumatics, Instrumentation Fittings, Manifolds & Valves

2/10, Singh Industrial Estate, Ram Mandir Road, Goregaon (W), Mumbai-400 104, India

◆ Phone: +91 22 28724724, +91 22 28738511 ◆ Fax: +91 22 28752130

◆ Email: sdind@vsnl.com ◆ www.sdinds.com

"We Deliver Confidence Through Quality Products."

**MALE CONNECTOR (STUD END PARALLEL THREAD) WITH ELASTOMERIC SEAL
INCH OD TUBES X BSP THREAD-G**

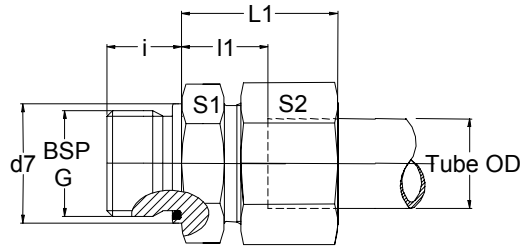

SIZES	SERIES	TUBE OD.	S1	S2	L1	l1	i	d7	BSP THREAD	
									G	PART NO
INCH OD TUBE	6000 PSI	1/4"	0.75	0.67	1.10	0.47	0.43	0.75	1/4"	4MCG-es
		3/8"	0.87	0.75	1.17	0.54	0.50	0.87	3/8"	6MCG-es
		1/2"	1.06	0.94	1.26	0.59	0.63	1.06	1/2"	8MCG-es
		3/4"	1.26	1.25	1.42	0.59	0.75	1.26	3/4"	12MCG-es
		1"	1.75	1.75	1.69	0.75	0.87	1.58	1"	16MCG-es
	3000 PSI	1 1/4"	1.97	1.97	1.90	0.83	0.98	1.97	1 1/4"	20MCG-es
		1 1/2"	2.17	2.36	2.20	0.98	1.00	2.17	1 1/2"	24MCG-es
2000 PSI	2"	2.84	2.75	2.22	1.05	1.00	2.84	2"	32MCG-es	
NB TUBE	6000 PSI	1/4"	0.94	1.06	1.26	0.55	0.43	0.90	1/4"	4MCNBG-es
		3/8"	1.06	1.25	1.44	0.61	0.50	0.98	3/8"	6MCNBG-es
		1/2"	1.26	1.41	1.41	0.57	0.63	1.16	1/2"	8MCNBG-es
		3/4"	1.41	1.61	1.61	0.67	0.75	1.37	3/4"	12MCNBG-es
	3000 PSI	1"	1.79	2.03	1.75	0.76	0.86	1.73	1"	16MCNBG-es
		1 1/4"	2.16	2.36	2.00	0.86	0.98	2.08	1 1/4"	20MCNBG-es
	2000 PSI	1 1/2"	2.50	2.50	2.11	1.00	1.00	2.36	1 1/2"	24MCNBG-es

S.D.INDUSTRIES.

An ISO 9001 : 2000 Company

Hydraulics, Pneumatics, Instrumentation Fittings, Manifolds & Valves

2/10, Singh Industrial Estate, Ram Mandir Road, Goregaon (W), Mumbai-400 104, India

◆ Phone: +91 22 28724724, +91 22 28738511 ◆ Fax: +91 22 28752130

◆ Email: sdind@vsnl.com ◆ www.sdinds.com

"We Deliver Confidence Through Quality Products."