

**MALE ELBOW (STUD END PARALLEL THREAD)  
METRIC OD TUBES X BSP THREAD-G**

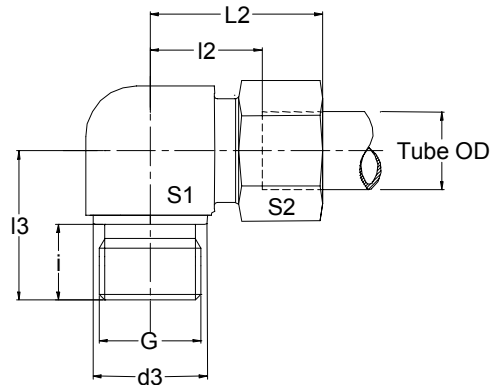

		SERIES	TUBE OD.	S1	S2	L2	l2	l3	i	G		PART NO.
METRIC SIZE TUBE	L	160 Kg/cm <sup>2</sup>	22	32	36	44	27.5	42	16	3/4"		ME22L-G12
		100 Kg/cm <sup>2</sup>	28	41	41	47	30.5	48	18	1"		ME28L-G16
			35	50	50	56	34.5	54	20	1 1/4"		ME35L-G20
			42	55	60	63	40	61	22	1 1/2"		ME42L-G24
	H	400 Kg/cm <sup>2</sup>	20	32	36	48	26.5	42	16	3/4"		ME20H-G12
			25	41	46	54	30	48	18	1"		ME25H-G16
		250 Kg/cm <sup>2</sup>	30	50	50	62	35.5	54	20	1 1/4"		ME30H-G20
			38	55	60	72	41	61	22	1 1/2"		ME38H-G24

**S.D.INDUSTRIES.**

An ISO 9001 : 2000 Company

**Hydraulics, Pneumatics, Instrumentation Fittings, Manifolds & Valves**

2/10, Singh Industrial Estate, Ram Mandir Road, Goregaon (W), Mumbai-400 104, India

◆ Phone: +91 22 28724724, +91 22 28738511 ◆ Fax: +91 22 28752130

◆ Email: [sdind@vsnl.com](mailto:sdind@vsnl.com) ◆ [www.sdinds.com](http://www.sdinds.com)

***"We Deliver Confidence Through Quality Products."***

**MALE ELBOW (STUD END PARALLEL THREAD)  
INCH OD TUBES X BSP THREAD-G**

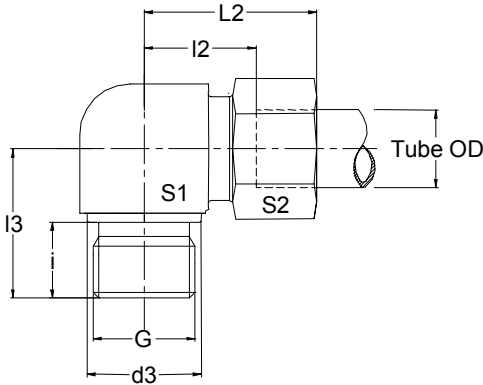

SERIES	TUBE OD.	S1	S2	L2	I2	I3	i	BSP THREAD		
								G	PART NO.	
INCH SIZE OD TUBE	6000 PSI	1/4"	0.67	0.67	1.18	0.59	0.88	0.38	1/8"	4-2MEG
		1/4"	0.75	0.67	1.32	0.69	0.94	0.43	1/4"	4MEG
		3/8"	0.75	0.75	1.22	0.59	0.98	0.43	1/4"	6-4MEG
		3/8"	0.87	0.75	1.29	0.94	1.06	0.50	3/8"	6MEG
		1/2"	0.87	0.94	1.54	1.18	1.18	0.50	3/8"	8-6MEG
		1/2"	1.06	0.94	1.50	1.14	1.30	0.63	1/2"	8MEG
		3/4"	1.06	1.25	1.81	1.38	1.42	0.63	1/2"	12-8MEG
		3/4"	1.25	1.25	1.93	1.50	1.61	0.75	3/4"	12MEG
		1"	1.42	1.75	1.93	1.46	1.89	0.75	3/4"	16-12MEG
	1"	1.61	1.75	2.13	1.65	1.97	0.87	1"	16MEG	
	3000 PSI	1 1/4"	1.75	1.97	2.48	1.97	2.17	0.87	1"	20-16MEG
		1 1/4"	1.97	1.97	2.60	2.08	2.32	0.98	1 1/4"	20MEG
		1 1/2"	2.16	2.36	2.83	2.24	2.40	1.00	1 1/2"	24MEG
NOM. BORE TUBE	6000 PSI	1/4"	0.87	1.06	1.42	0.70	1.18	0.43	1/4"	4MENBG
		1/4"	0.94	1.06	1.50	0.78	1.25	0.50	3/8"	4-6MENBG
		3/8"	1.06	1.25	1.69	0.93	1.38	0.50	3/8"	6MENBG
		3/8"	1.06	1.25	1.77	1.01	1.50	0.63	1/2"	6-8MENBG
		1/2"	1.18	1.41	1.89	1.04	1.57	0.63	1/2"	8MENBG
		1/2"	1.25	1.41	1.97	1.12	1.69	0.75	3/4"	8-12MENBG
		3/4"	1.42	1.61	2.03	1.06	1.97	0.75	3/4"	12MENBG
	3000 PSI	1"	1.81	2.04	2.40	1.42	2.24	0.87	1"	16MENBG
		1 1/4"	2.16	2.36	3.07	1.93	2.56	1.00	1 1/4"	20MENBG
	2000 PSI	1 1/2"	2.50	2.75	3.15	2.05	2.83	1.00	1 1/2"	24MENBG

**S.D.INDUSTRIES.**

An ISO 9001 : 2000 Company

**Hydraulics, Pneumatics, Instrumentation Fittings, Manifolds & Valves**

2/10, Singh Industrial Estate, Ram Mandir Road, Goregaon (W), Mumbai-400 104, India

◆ Phone: +91 22 28724724, +91 22 28738511 ◆ Fax: +91 22 28752130

◆ Email: [sdind@vsnl.com](mailto:sdind@vsnl.com) ◆ [www.sdinds.com](http://www.sdinds.com)

**"We Deliver Confidence Through Quality Products."**